

# BELKI Central System - Dimensions

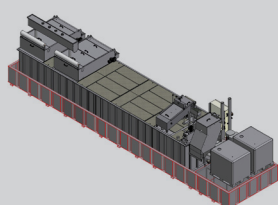

## Floor space for a BELKI Central System (in mm):

2 m <sup>3</sup>	L x W	2300 x 1600	
3 m <sup>3</sup>	L x W	2300 x 1900	
6 m <sup>3</sup>	L x W	3900 x 2500	
9/10 m <sup>3</sup>	L x W	6000 x 2500	
12 m <sup>3</sup>	L x W	6000 x 2500	(Higher than the 10m <sup>3</sup> )
15 m <sup>3</sup>	L x W	7200 x 2500	(Long version)
15 m <sup>3</sup>	L x W	6300 x 2500	(High version)
20 m <sup>3</sup>	L x W	7200 x 2500	(Long version)
20 m <sup>3</sup>	L x W	6300 x 2500	(High version)

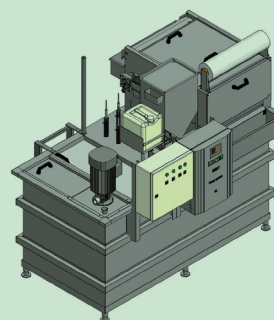

## Collection tray

Additional space for a collection tray at the BELKI Central System, please add the following dimensions:

Length = + 300 mm  
Height = + 300 mm

## Drums

Additional space for 2x 200 L drums at the BELKI Central System, please add the following dimensions:  
Length = + 800 mm

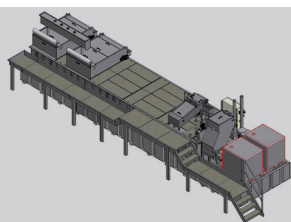
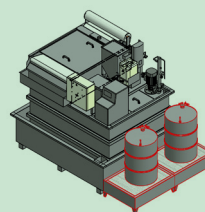

## Intermediate Bulk Container (IBC)

Additional space for 2x 1000 L IBC tanks at the BELKI Central System, please add the following dimensions:

Length = + 1400 mm

**BELKI Filtertechnik GmbH**  
Ostpromenade 54, D-52525 Heinsberg  
Tel +49 (0) 2452 10651-27  
www.belki.de • info@belki.de



Filtration with capacity

Hovedkontor / Headoffice / Hauptsitz:  
**BELKI teknik ApS**  
Fårupvej 19, DK-8840 Rødskær  
Tel +45 8665 8811  
www.belki.dk • post@belki.dk

Presented by / Überreicht durch:

